

## Ordering details



Type	Rated voltage	Thread	Ex-d Blanking plug	Order No.
Planete 400 AD DL	220 - 240 V AC	2 x 3/4" NPT, metal thread	1	<b>NOR 000 005 160 055</b>
Planete 400 AD DL		2 x M25, metal thread	1	<b>NOR 000 005 160 056</b>
AB 12108-EVG		2 x 3/4" NPT, metal thread	1	<b>NOR 000 005 060 820</b>
EE 11 PL 220 - 240 V, 1.5 h	220 - 240 V AC	2 x 3/4" NPT, metal thread	1	<b>NOR 000 005 160 013</b>
EE 11 PL 108 - 127 V, 1.5 h	108 - 127 V AC	2 x 3/4" NPT, metal thread	1	<b>NOR 000 005 160 014</b>

Other silk-screen pictograms or inscriptions available on request

A wide selection of cable glands can be found at [www.crouse-hinds.de/products](http://www.crouse-hinds.de/products) or in the catalogue Part 2, Section 3

## Accessories

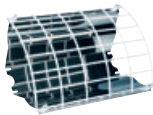

Type	OU	Order No.
Pictogram foil with arrow 3 h	1	<b>400 71 354 381</b>
Pictogram foil with arrow 9 h	1	<b>400 71 354 380</b>
Pictogram foil with arrow 6 h	1	<b>400 71 354 382</b>
Pictogram foil with „EXIT“	1	<b>400 71 354 383</b>
Reflector RAB 108 (AISI 304)	1	<b>NOR 003 045 060 471</b>
Reflector RAB 108 (AISI 304) + guard (steel white epoxy coating)	1	<b>NOR 003 045 060 819</b>
Reflector RAB 108 (AISI 316)	1	<b>NOR 003 165 060 471</b>
Reflector RAB 108 (AISI 316) + guard (steel white epoxy coating)	1	<b>NOR 003 165 060 819</b>

# 3.4

## Polar curves / dimension drawing

AB 12108 EVG / Planete 400 AD DL / EE 11 PL

3

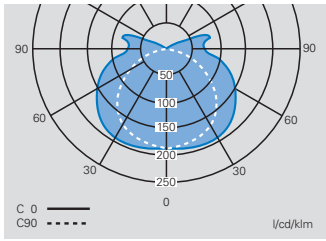

**Polar curve  
AB 12108-EVG**

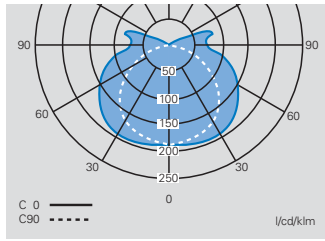

**Polar curve  
EE11 PL**

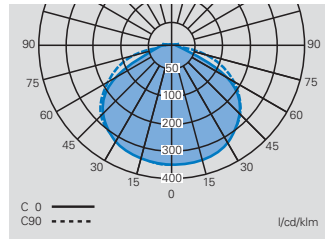

**Polar curve  
Planete 400**

### AB 12108-EVG / EE11 PL / Planete 400

### Reflector / Reflector with guard

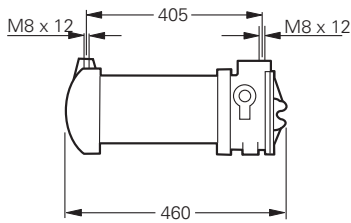
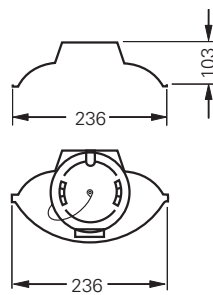
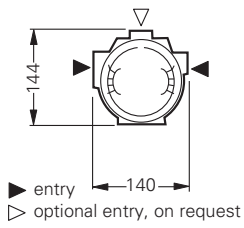

Dimensions in mm



3

## Technical data

	Planete 400 AD DL	AB 12108 EVG	EE 11 PL
EC-Type Examination Certificate	LOM 03 ATEX 2036 X	LOM 02 ATEX 2013 X	LOM 03 ATEX 2036 X
IECEX Certificate of Conformity		IECEX BK1 07.0008 X	
Marking accd. to 94/9/EC	Ⓢ II 2 G Ex d IIC T6 Gb Ⓢ II 2 D Ex tb IIIC T85 °C Db	Ⓢ II 2 G Ex de IIC T6/T5 Gb/ Ⓢ II 2 D Ex tb IIIC T58 °C/T73 °C Db	Ⓢ II 2 G Ex de IIC T6 Gb Ⓢ II 2 D Ex tb IIIC T85 °C Db
Marking accd. to IECEx		Ex de IIC T6/T5 Gb Ex tb IIIC T58 °C/T73 °C Db	
Permissible ambient temperature	-20 °C up to +55 °C	-20 °C up to +55 °C (temperature class T5), -20 °C up to +40 °C (temperature class T6)	-20 °C up to +55 °C
specified data	-5 °C up to +35 °C	-5 °C up to +35 °C	-5 °C up to +35 °C
Battery	1.7 Ah NC-accumulator		4 Ah NC-accumulator
Rated power consumption	1.1 W	approx. 16 VA	approx. 16 VA
Rated voltage	220 - 240 V AC	220 - 230 V AC 220 V DC +25 %/-20 %	220 - 240 V AC
Rated voltage (optional)	108 V - 127 V AC		108 V - 127 V AC
Frequency	50 - 60 Hz	50 Hz	
Charging duration	≥ 14 h		≥ 24 h
Power factor cos φ	0.95	0.95	0.95
Rated operating duration	1.0 h		1.5 h
Circuit		EVG	
Protection class	I	I	I
Viewing distance	12 m	12 m	12 m
Lamp / Illuminant	32 LEDs , 5.5 W	1 x 8 W/T5-fluorescent lamp for mains- and emergency operation	1 x 11 W compact fluorescent lamp for emergency operation
Lamp cap	--	G5 accord. IEC 60061	2G7 accord. IEC 60061
Luminous flux in emergency operation	330 lm <sup>1)</sup>	337 lm (75 %) <sup>1)</sup>	630lm <sup>1)</sup>
Pilot lamp			3 W incandescent lamp (Netzbetrieb)
Dimensions (L x W x H)	460 x 144 x 140 mm	460 x 144 x 140 mm	460 x 144 x 140 mm
Connecting terminals	3 x loop terminal 2.5 mm <sup>2</sup>	3 x loop terminal 2.5 mm <sup>2</sup>	3 x loop terminal 2.5 mm <sup>2</sup>
Weight	5.0 kg	5.3 kg	5.6 kg
Cable glands / gland plates / enclosure drilling	2 x 3/4" thread, 1 x 3/4" screw plug or 2 x M25 thread, 1 x M25 screw plug	2 x 3/4" thread, 1 x 3/4" screw plug or 2 x M25 thread, 1 x M25 screw plug	2 x 3/4" thread, 1 x 3/4" screw plug or 2 x M25 thread, 1 x M25 screw plug
Type of mounting	ceiling-/wall mounting	ceiling-/wall mounting	ceiling-/wall mounting
Degree of protection accd. to EN 60529	IP67	IP67	IP67
Protective cover / protective bowl	borosilicate glass	borosilicate glass	borosilicate glass

<sup>1)</sup> depends on used lamps