

Ordering details

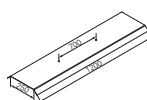

Type	OU	Order No.
Pole-system bent 90°		
Light pole, 90° bend and drilling hole f. LTR 48 and LTRS 48: type LM 48 - 2300/300 - FT, hot-dip galvanized	1	2 2480 520 001
Light pole 90° bend and drilling hole f. LTR 48 and LTRS 48: type LM 48 - 1900/300 - FT, hot-dip galvanized	1	2 2480 520 002
Light fitting support pipe with cable outlet: type LTR 48 - 600 - FT, hot-dip galvanized	1	2 2480 530 001
Light fitting support pipe with cable outlet: type LTR 48 - 1200 - FT, hot-dip galvanized	1	2 2480 530 002
Light fitting support pipe with cable outlet: type LTR 48 - 1500 - FT, hot-dip galvanized	1	2 2480 530 003
Light fitting support pipe clamp 90° twisted: type LTRS 48 - FT, hot-dip galvanized	1	2 2480 550 012
Pole-system bent 45°		
Light pole, 45° bend, for pole-mounting light fittings: type LMZ 48 - 1900/190 - FT, hot-dip galvanized	1	2 2480 520 006
Light pole, 45° bend, , e.g. for floodlights: type LM 48 - 1900/190 - FT, hot-dip galvanized	1	2 2480 520 007
Light pole whip form, 45° bend: type LMP 48 - 1900/1300 - FT, hot-dip galvanized	1	2 2480 520 003
Light pole whip form, 45° bend: type LMP 48 - 2100/1300 - FT, hot-dip galvanized	1	2 2480 520 004
Light pole whip form, 45° bend: type LMP 48 - 2100/800 - FT, hot-dip galvanized	1	2 2480 520 005
Wall-mounted light pole whip form, 45° bend, with cable outlet: type LMW 48 - 500/1300 - FT, hot-dip galvanized	1	2 2480 520 008
Wall-mounted light pole whip form, 45° bend, with cable outlet: type LMW 48 - 500/800 - FT, hot-dip galvanized	1	2 2480 520 009
Light pole fixture for wall mounting, set 2 pcs.: type LMHW 48 - FT, hot-dip galvanized	1	2 2480 550 001
Light pole clamp		
Light pole clamp, fixed, UMHS 48/48 - FT, hot-dip galvanized	1	2 2480 550 002
Light pole clamp, fixed, with pole slip protection UMHSD 48/48 - FT, hot-dip galvanized	1	2 2480 550 003
Light pole clamp, swivel, with pole slip protection, UMHK 48/48 - ER, stainless steel	1	2 2480 550 004
Light pole clamp, fixed, UMHS 48/48 - ER, stainless steel	1	2 2480 550 005
Light pole clamp, fixed, with pole slip protection UMHSD 48/48 - ER, stainless steel	1	2 2480 550 006
Light pole clamp, swivel, with pole slip protection, UMHK 48/48 - FT, hot-dip galvanized	1	2 2480 550 007
End caps for poles and pipes		
End cap with cable outlet Ø 15 mm: type SEL 48 - K, plastic	1	2 2480 550 015
End cap closed: type SEG 48 - K, plastic	1	2 2480 550 016
End cap open: type SEO 48 - K, plastic	1	2 2480 550 115
Canopy for fluorescent light fittings		
Canopy for fluorescent light fittings 18 W LSD 1200 - ER 1200 mm length, hole spacing: 400 mm	1	2 2480 540 001
Canopy for fluorescent light fittings 18 W LSD 1600 - ER 1600 mm length, hole spacing: 700 mm	1	2 2480 540 002

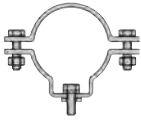

Ordering details

Type	OU	Order No.
Pipe clamps		
 2 pcs. pipe clamps R12 (1 1/4"), Ø 38 - 42 mm with screws and polyamide washer, hot-dip galvanized	1	2 2480 462 000
2 pcs. pipe clamps R14 (1 1/4"), Ø 38 - 42 mm with screws and polyamide washer, stainless steel	1	2 2480 464 000
2 pcs. pipe clamps R22 (1 1/2"), Ø 47 - 51 mm with screws and polyamide washer, hot-dip galvanized	1	2 2480 472 000
2 pcs. pipe clamps R24 (1 1/2"), Ø 47 - 51 mm with screws and polyamide washer, stainless steel	1	2 2480 474 000
2 pcs. pipe clamps R32 (2"), Ø 56 - 60 mm with screws and polyamide washer, hot-dip galvanized	1	2 2480 482 000
2 pcs. pipe clamps R34 (2"), Ø 56 - 60 mm with screws and polyamide washer, stainless steel	1	2 2480 484 000
1 pcs. pipe clamp A8 (1 1/2") D 47 - 51 mm for AB 12.. with screws and polyamide washer, hot-dip galvanized	1	NOR 000 005 009 211
1 pcs. pipe clamp A9 (2") D 56 - 60 mm for AB 12.. with screws and polyamide washer, hot-dip galvanized	1	NOR 000 005 009 229
2 pcs. pipe clamp, two-part, for pipe mounting LB 48 - FT with screws and polyamide washer, hot-dip galvanized	1	2 2480 550 010
Fixing accessories		
2 pcs. luminaire mounting bracket with 30° angle, wall mounting LH 30 - FT, hot-dip galvanized	1	2 2480 550 013
2 pcs. luminaire mounting bracket with 45° angle, wall mounting LH 45 - FT, hot-dip galvanized	1	2 2480 550 014
2 pcs. wall mounting bracket with 30° angle, with screws and polyamide washer, hot-dip galvanized	1	2 2480 000 122
1 pcs. wall bracket 45° with screws and polyamide washer, hot-dip galvanized	1	NOR 000 005 009 196
1 pcs. wall bracket W 27, 15°, for pole-mounting fitting Ø 42 mm, hot-dip galvanized	1	2 2483 027 000
2 pcs. ceiling mounting bracket D 92 with screws and polyamide washer, stainless steel	1	2 2480 092 000
1 pcs. ceiling mounting bracket A5 with screws and polyamide washer, hot-dip galvanized	1	NOR 000 005 009 162
2 pcs. C-bracket for luminaire mounting LAB-C50 - ER, stainless steel	1	2 2480 550 011
2 pcs. hexagon screw M8 x 20 for luminaire mounting, with polyamide washer	1	2 2480 054 000
2 pcs. eye bolt M8 for luminaire mounting, hot-dip galvanized	1	2 2480 002 000
2 pcs. eye bolt M8 for luminaire mounting, stainless steel	1	2 2480 004 000
1 pcs. eye bolt M8 - A1 for luminaire mounting, hot-dip galvanized	1	NOR 000 005 009 261

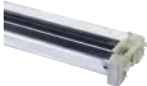
Accessories

Type	Application	Order No.
 LED module 400	for eLLK 92 018/18 LED Ready / eLLK 92 LED 400	1 2255 213 101
LED module 800	for eLLK 92 036/36 LED Ready / eLLK 92 LED 800	1 2256 226 101
LED module 400	for eLLK 92 018/18 with conversion kit	1 2256 226 501
LED module 800	for eLLK 92 036/36 with conversion kit	1 2256 226 501
Single-ended through-wiring 2/6 with 2 entries M25, incl. terminals and mounting material	for eLLM 92 pole mounting light fitting	2 2218 602 000
 Fluorescent lamp G13 T8/Ø 26 mm 18 W 840 - 1350 lm		3 2475 900 001
Fluorescent lamp G13 T8/Ø 26 mm 36 W 840 - 3350 lm		3 2475 900 002
Fluorescent lamp G13 T8/Ø 26 mm 58 W 840 - 5200 lm		3 2475 900 003
Fluorescent lamp Fa6 T8 18 W Long-Life		3 2475 900 084
Fluorescent lamp Fa6 T8 36 W Long-Life		3 2475 900 085
Fluorescent lamp G13 T8 18 W Ultimate 840		3 2475 900 087
Fluorescent lamp G13 T8 36 W Ultimate 840		3 2475 900 088
Fluorescent lamp G13 T8 58 W Ultimate 840		3 2475 900 089
Hexagon box spanner SW 13 for opening/closing fluorescent light fittings eLLK/M and nLLK/M		3 2485 000 005

Light pole 90° bended

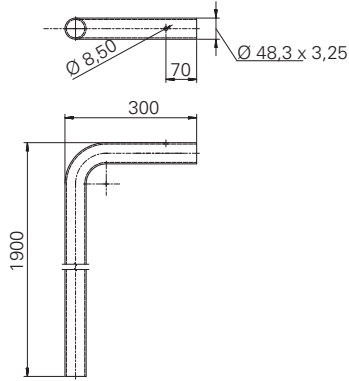

Light fitting support pipe with cable outlet

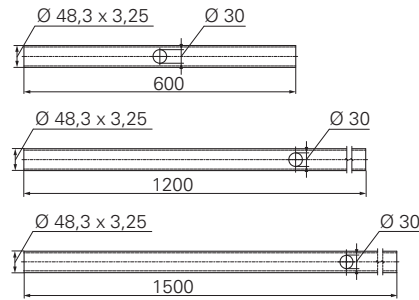

Light fitting support pipe clamp 90° twisted:

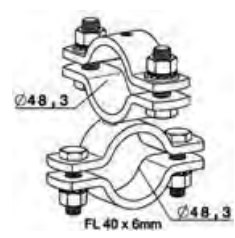

LMZ 48 - 1900/190 - FT

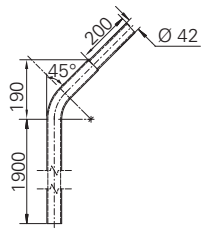

LM 48 - 1900/190 - FT

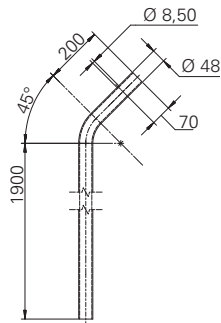

LMW 48 - 500/800 - FT

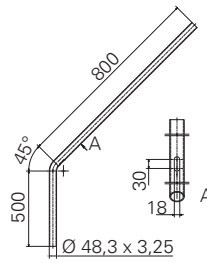

LMW 48 - 500/1300 - FT

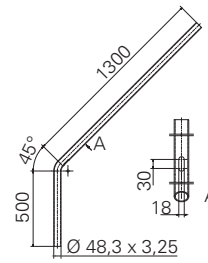

LMP 48 - 1900/1300 - FT/
LMP 48 - 2100/1300 - FT/
LMP 48 - 2100/800 - FT

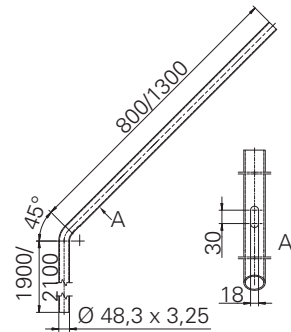

LMHW 48 - FT

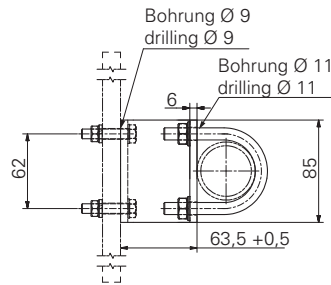

UMHS 48/48 - FT/ER - UMHSD 48/48 - FT/ER

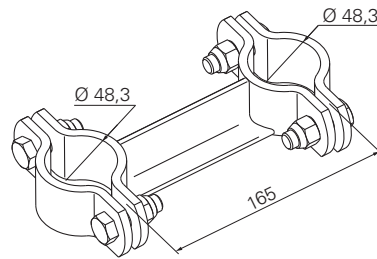

UMHK 48/48 - ER / FT

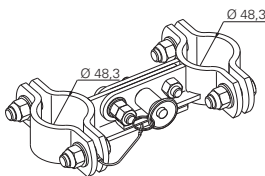

End cap SEL 48 / SEG / SEO

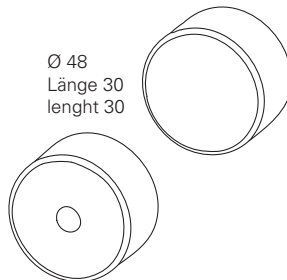

LSD 1200 - ER/ LSD 1600 - ER

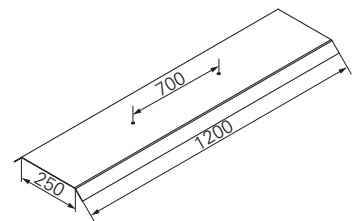

2.17

Dimension drawing

Fixingsystems / Accessories

Pipe clamp

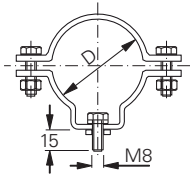

Type	D
R12/R14	38-42 mm
R22/R24/A8	47-51 mm
R32/R34/A9	56-60 mm

Pipe clamp LB 48 - FT

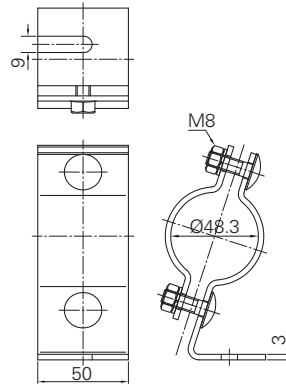

Leuchtenmontagebügel 30 °
LH 30 - FT

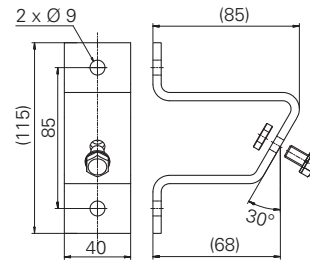

45°
LH 45 - FT

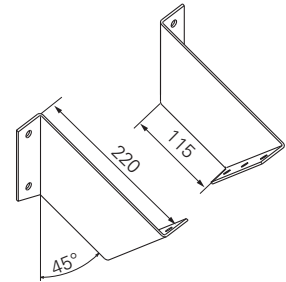

Wandarm W27

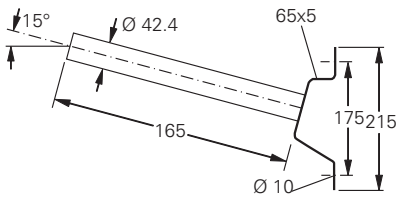

Ceiling bracket D92

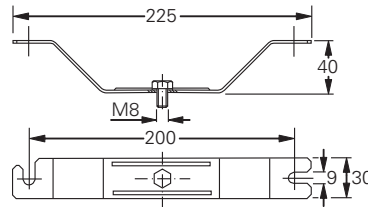

C-bracket

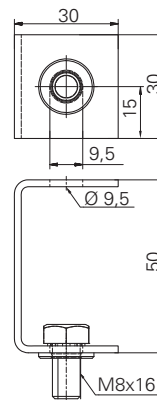

Eye bolt

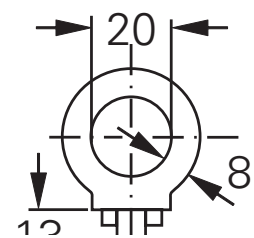

Wandbügel 45°

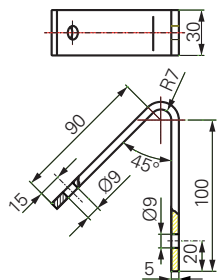

Ceiling bracket A5

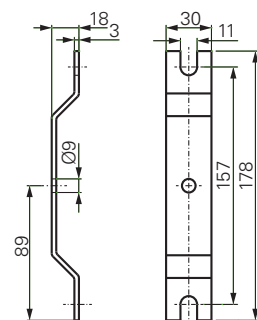

Dimensions in mm