

**Industrial use: 125A 4-pole and 5-pole up to 690 V**

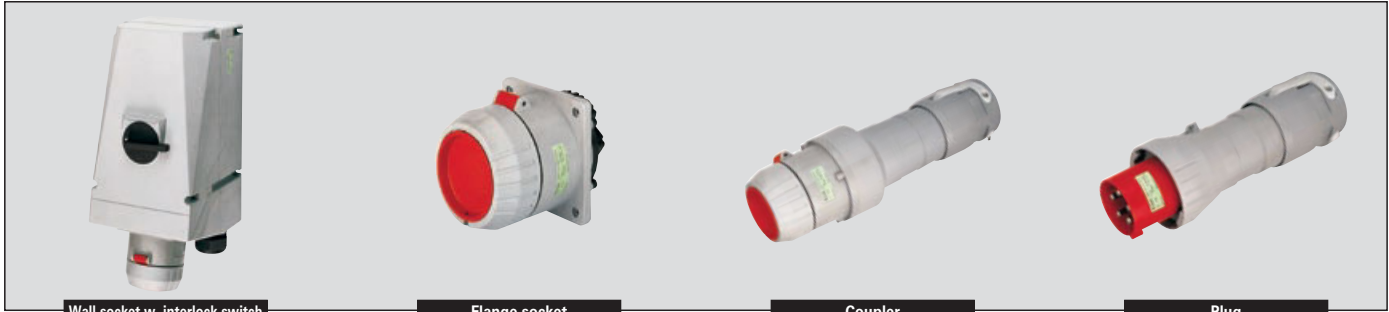

**Technical data**

**Plugs and receptacles - industrial use acc. to IEC 60309-1/2 up to 690 V**

Permissible ambient temperature	-20 °C to +40 °C / -40 °C to +40 °C (optional) <sup>1)</sup>
Rated voltage	690 V~
Rated current	125 A
Frequency	50/60 Hz
External back-up fuse, max.	without therm. protection: 125 A
Protection class	I
Degree of protection accd. to EN 60529	IP66

**Wall socket with interlock switch**

Rated making / Rated breaking capacity AC-23 accd. EN 60947-3	
for wall socket with switch	$U_e$ 500 V / $I_e$ 70 A
Cable entry	1 x M63 Ø 27 - 48 mm, 1 x M63 thread plug plastic
Connecting terminals	2 x 10 - 70 mm <sup>2</sup>
Enclosure material	glass-fibre reinforced polyester

**Plug**

Cable entry	Ø 31 - 58 mm
Connecting terminals	1 x 2.5 - 35 mm <sup>2</sup> / with pin cable lug <sup>2)</sup> 35 mm <sup>2</sup>
Enclosure material	Polyamide

**Coupler**

Cable entry	Ø 31 - 58 mm
Connecting terminals	1 x 16 - 35 mm <sup>2</sup>
Enclosure material	Polyamide

**Flange socket**

Connecting terminals	1 x 2.5 - 35 mm <sup>2</sup>
Enclosure material	Polyamide

<sup>1)</sup> extended temperature range on request

<sup>2)</sup> use supplied cable lugs

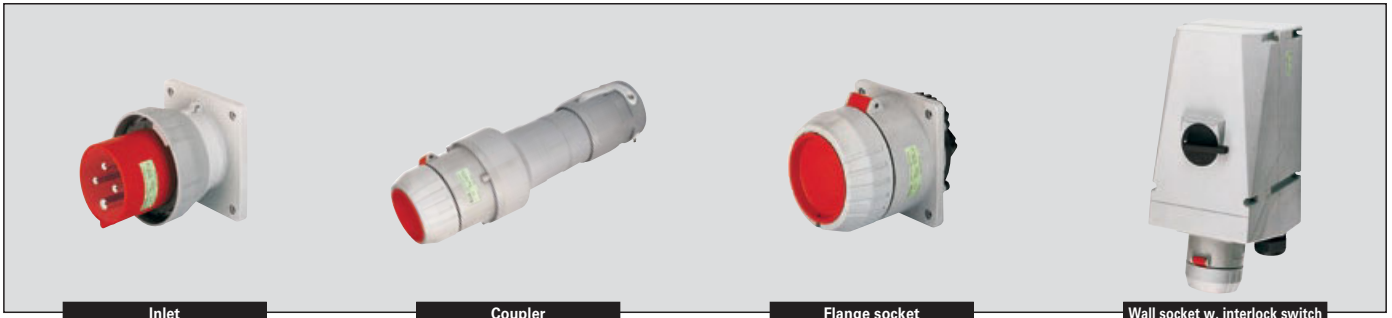

## Ordering details

Voltage	h	Type	Weight approx.	Order No.
<b>Type 125 A 4-pole</b>				
200-250 V		Wall socket with interlock switch	8.6 kg	<b>GHG 525 4409 R0001</b>
		Plug	1.3 kg	<b>GHG 525 7409 R0001</b>
		Coupler	2.1 kg	<b>GHG 525 3409 R0001</b>
		Flange socket	1.4 kg	<b>GHG 525 8409 R0001</b>
		Inlet	0.9 kg	<b>GHG 525 9409 R0001</b>
380-415 V		Wall socket with interlock switch	8.6 kg	<b>GHG 525 4406 R0001</b>
		Plug	1.3 kg	<b>GHG 525 7406 R0001</b>
		Coupler	2.1 kg	<b>GHG 525 3406 R0001</b>
		Flange socket	1.4 kg	<b>GHG 525 8406 R0001</b>
		Inlet	0.9 kg	<b>GHG 525 9406 R0001</b>
480-500 V		Wall socket with interlock switch	8.6 kg	<b>GHG 525 4407 R0001</b>
		Plug	1.3 kg	<b>GHG 525 7407 R0001</b>
		Coupler	2.1 kg	<b>GHG 525 3407 R0001</b>
		Flange socket	1.4 kg	<b>GHG 525 8407 R0001</b>
		Inlet	0.9 kg	<b>GHG 525 9407 R0001</b>
600-690 V		Wall socket with interlock switch	8.6 kg	<b>GHG 525 4405 R0001</b>
		Plug	1.3 kg	<b>GHG 525 7405 R0001</b>
		Coupler	2.1 kg	<b>GHG 525 3405 R0001</b>
		Flange socket	1.4 kg	<b>GHG 525 8405 R0001</b>
		Inlet	0.9 kg	<b>GHG 525 9405 R0001</b>
<b>Type 125 A 5-pole</b>				
200-250 V		Wall socket with interlock switch	8.8 kg	<b>GHG 525 4506 R0001</b>
380-415 V		Plug	1.4 kg	<b>GHG 525 7506 R0001</b>
		Coupler	2.2 kg	<b>GHG 525 3506 R0001</b>
		Flange socket	1.5 kg	<b>GHG 525 8506 R0001</b>
		Inlet	1.1 kg	<b>GHG 525 9506 R0001</b>

Other voltage ranges and versions available on request

## Accessories

### Plug cap for plugs

Type	OU	Order No.
Set of pin cable lug 50 mm <sup>2</sup> (5 pcs. for plug)	5	<b>GHG 510 1916 R0002</b>
Plug cap 4-pole/5-pole	1	<b>GHG 510 1901 R0007</b>

**Industrial use: 125A 4-pole and 5-pole up to 690 V |**

1

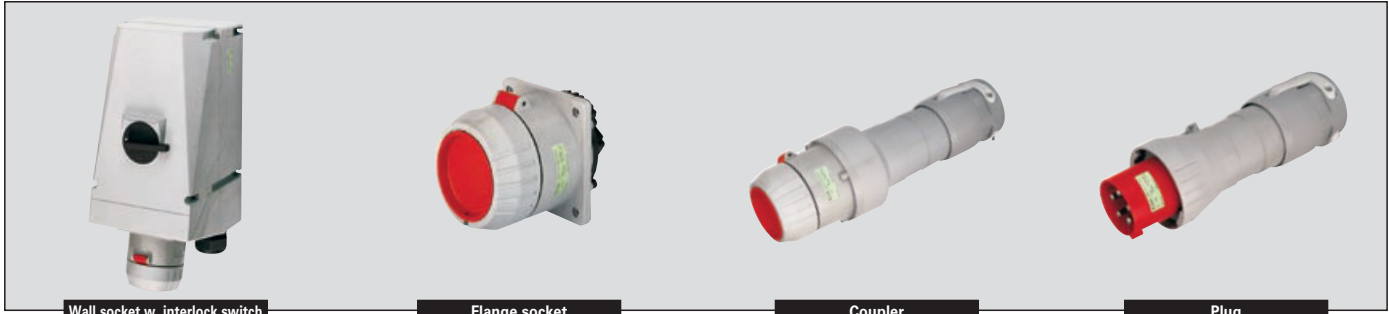

Wall socket w. interlock switch

Flange socket

Coupler

Plug

**Dimension drawing | Wiring diagram**

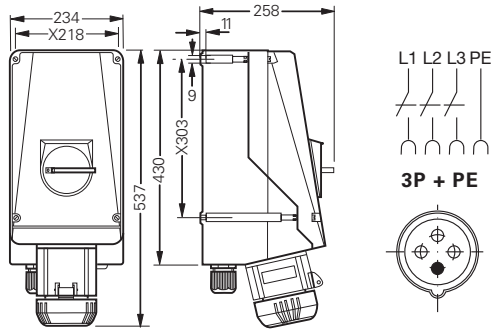

Wall socket 4-pole

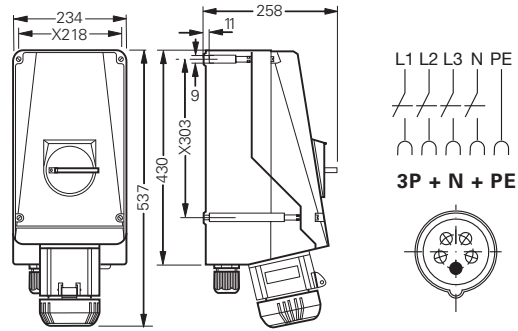

Wall socket 5-pole

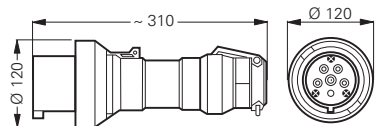

Plug 4-pole

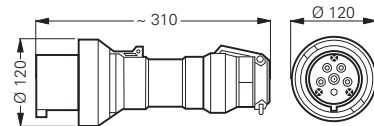

Plug 5-pole

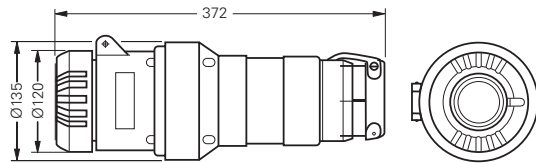

Coupler 4-pole

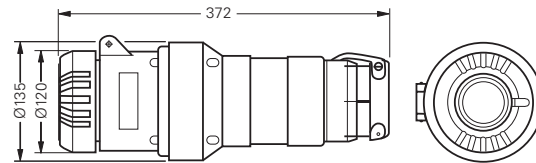

Coupler 5-pole

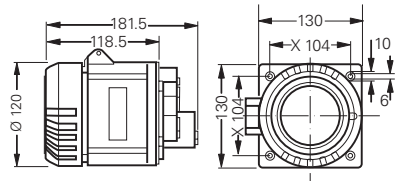

Flange socket 4-pole

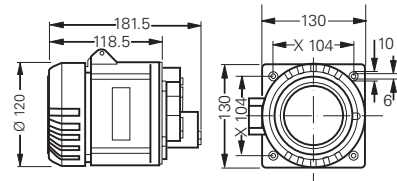

Flange socket 5-pole

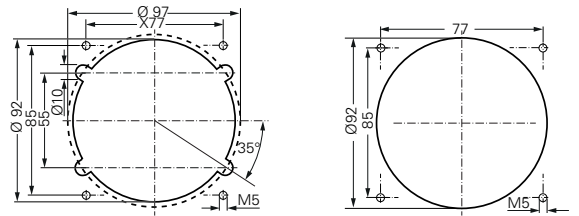

Assembly dimensions flange socket

Assembly dimensions inlet

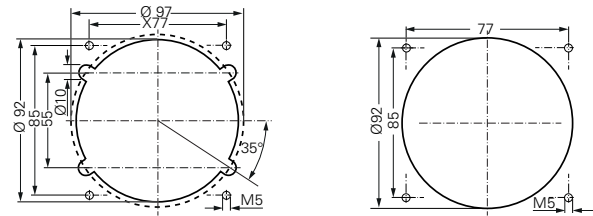

Assembly dimensions flange socket

Assembly dimensions inlet

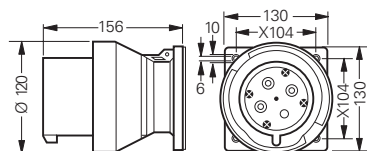

Inlet 4-pole

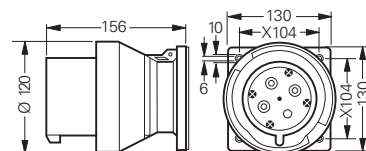

Inlet 5-pole

X = fixing dimensions

Dimensions in mm