

16 A 3-pole, 4-pole and 5-pole up to 690 V



Technical data

Ex-plugs and receptacles acc. to IEC 60309-1/2 16A	
Marking accd. to 94/9/EC	Ⓔ II 2 G Ex ed IIC T6 / Ⓔ II 2 D Ex tD A21 IP66 T80 °C
EC-Type Examination Certificate	Wall socket, plug and coupler: PTB 99 ATEX 1039 Flange socket: PTB 99 ATEX 1040 U
IECEX Certificate of Conformity	IECEX BKI 04.0002
Marking accd. to IECEx	Ex ed [ia] IIC T6/T5
Permissible ambient temperature	-20°C up to +40°C ¹⁾
Rated voltage	up to 400 V, (3-pole) / 690 V, (4-pole) / 500 V, (5-pole) AC
Rated current	16 A
Frequency	up to 400 Hz
Rated making / Rated breaking capacity AC-3 accd. EN 60947-3	U _o 250 V / I _o 16 A (3-pole) U _o 690 V / I _o 16 A (4-pole) U _o 500 V / I _o 16 A (5-pole)
External back-up fuse, max.	without therm. protection: 16 A with therm. protection: 35 A gL (rated current 16 A set to)
Protection class	I
Degree of protection accd. to EN 60529	IP66

Wall socket	
Cable entry	1 x M25 Ø 8 - 17 mm, 1 x M25 plastic Ex-screw plug or 2 x metal thread M20 with plastic Ex-screw plug
Connecting terminals	2 x 1 - 4 mm ²
Enclosure material	glass-fibre reinforced polyester

Plug	
Cable entry	Ø 8 - 19 mm (3-pole) / Ø 8 - 21 mm (4-pole) / 12 - 21 mm (5-pole)
Connecting terminals	1 x 1.0 - 2.5 mm ²
Enclosure material	Polyamide

Coupler	
Cable entry	Ø 8 - 19 mm (3-pole) / Ø 8 - 21 mm (4-pole) / 12 - 21 mm (5-pole)
Connecting terminals	2 x 1 - 4 mm ²
Enclosure material	Polyamide

Flange socket	
Connecting terminals	2 x 1 - 4 mm ²
Enclosure material	Polyamide

1) extended temperature range on request





Ordering details

Voltage	h	Type	Aux. contact	Cable entry	Weight approx.	Order No.
Type 16 A 3-pole						
110-130 V		Wall socket	-	M25 KU	1.2 kg	GHG 511 4304 R0001
		Wall socket	-	M20 GE	1.2 kg	GHG 511 4304 R0002
		Wall socket	-	M20 ME	1.3 kg	GHG 511 4304 R3001
		Wall socket	-	M20 GM	1.3 kg	GHG 511 4304 R3003
		Flange socket	-		0.4 kg	GHG 511 8304 R0001
		Coupler			0.7 kg	GHG 511 3304 R0001
		Plug			0.35 kg	GHG 511 7304 R0001



Ordering details

Voltage	h	Type	Aux. contact	Cable entry	Weight approx.	Order No.
Type 16 A 3-pole						
200-250 V		Wall socket	–	KU	1.2 kg	GHG 511 4306 R0001
		Wall socket	–	GE	1.2 kg	GHG 511 4306 R0002
		Wall socket	–	ME	1.3 kg	GHG 511 4306 R3001
		Wall socket	–	GM	1.3 kg	GHG 511 4306 R3003
		Flange socket	–		0.4 kg	GHG 511 8306 R0001
		Coupler	–		0.7 kg	GHG 511 3306 R0001
		Plug	–		0.35 kg	GHG 511 7306 R0001

Type 16 A 4-pole						
200-250 V		Wall socket	–	KU	1.8 kg	GHG 511 4409 R0001
		Wall socket	–	ME	1.9 kg	GHG 511 4409 R3001
		Wall socket	–	GM	2.0 kg	GHG 511 4409 R3003
		Flange socket	–		1.0 kg	GHG 511 8409 R0001
		Coupler	–		1.7 kg	GHG 511 3409 R0001
		Plug	–		0.7 kg	GHG 511 7409 R0001
		380-415 V		Wall socket	–	KU
Wall socket	–			ME	1.9 kg	GHG 511 4406 R3001
Wall socket	–			GM	2.1 kg	GHG 511 4406 R3003
Wall socket	yes			KH	1.8 kg	GHG 511 4406 R0501
Flange socket	–				1.0 kg	GHG 511 8406 R0001
Coupler	–				1.7 kg	GHG 511 3406 R0001
Plug	–				0.7 kg	GHG 511 7406 R0001
480-500 V		Wall socket	–	KU	1.8 kg	GHG 511 4407 R0001
		Wall socket	–	ME	1.9 kg	GHG 511 4407 R3001
		Wall socket	yes	KH	1.8 kg	GHG 511 4407 R0501
		Flange socket	–		1.0 kg	GHG 511 8407 R0001
		Coupler	–		1.7 kg	GHG 511 3407 R0001
		Plug	–		0.7 kg	GHG 511 7407 R0001
		600-690 V		Wall socket	–	KU
Wall socket	–			ME	1.9 kg	GHG 511 4405 R3001
Wall socket	yes			KH	1.8 kg	GHG 511 4405 R0501
Flange socket	–				1.0 kg	GHG 511 8405 R0001
Coupler	–				1.7 kg	GHG 511 3405 R0001
Plug	–				0.7 kg	GHG 511 7405 R0001

Type 16 A 5-pole						
200-250 V 380-415 V		Wall socket	–	KU	1.8 kg	GHG 511 4506 R0001
		Wall socket	–	ME	1.9 kg	GHG 511 4506 R3001
		Wall socket	yes	KH	1.8 kg	GHG 511 4506 R0501
		Wall socket	–	GM	2.1 kg	GHG 511 4506 R3003
		Flange socket	–		1.0 kg	GHG 511 8506 R0001
		Coupler	–		1.7 kg	GHG 511 3506 R0001
		Plug	–		0.7 kg	GHG 511 7506 R0001

Other voltage ranges and versions available on request

KU = 1 x plastic cable glands M25 for Ø 8-17 mm, 1 x M25 plastic Ex-screw plug

KH = 2 x plastic cable glands M25 for Ø 8-17 mm, aux. contact, 1 NO

ME = 2 x metal thread M20

GE = 2x plastic thread M20 without gland/screw plug

GM = 2 x metal thread M20 with screw plug, with external earth bolt M6

16A 3-pole, 4-pole and 5-pole up to 690 V



Dimension drawing | Wiring diagram

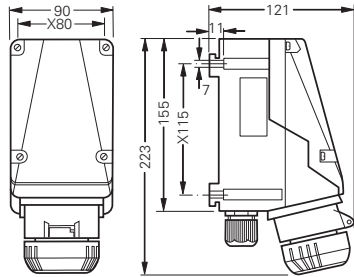

Wall socket 3-pole

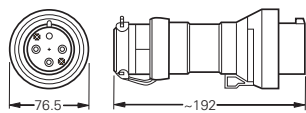

Plug 3-pole

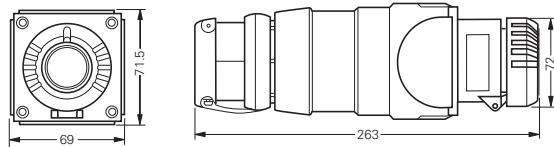

Coupler 3-pole

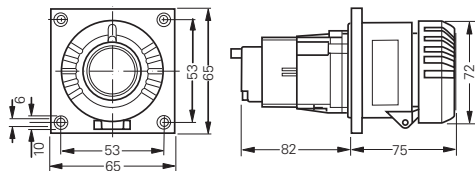

Flange socket 3-pole

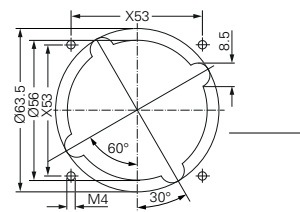

Assembly dimensions flange socket

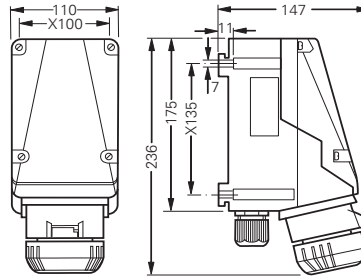

Wall socket 4/5-pole

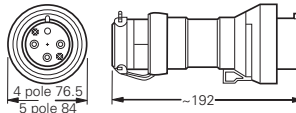

Plug 4/5-pole

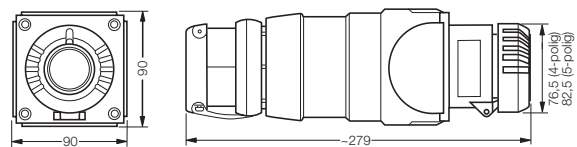

Coupler 4/5-pole

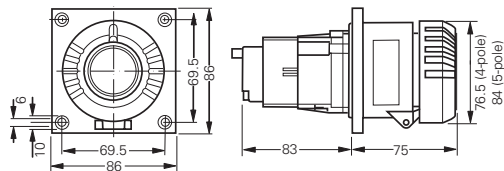

Flange socket 4/5-pole

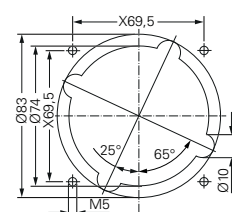

Assembly dimensions flange socket X = fixing dimensions

without aux. contact



1 P + N + PE



without aux. contact



3P + PE



with aux. contact

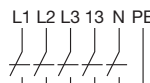

3P + AUX + PE



without aux. contact

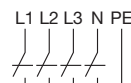

3P + N + PE



with aux. contact

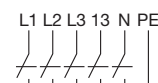

3P + N + AUX + PE



Dimensions in mm

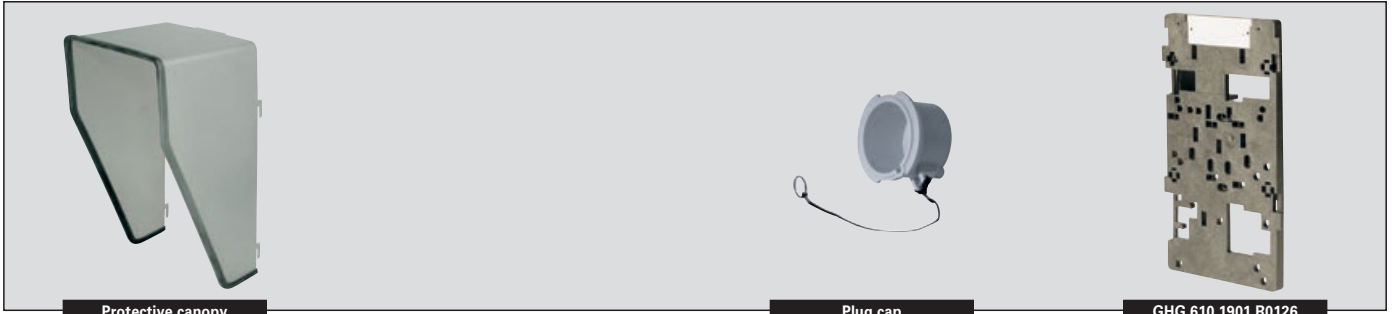

Protective canopy

Plug cap

GHG 610 1901 R0126

Accessories

Mounting plates for wall sockets 16 A

Type	Application	Fixing method	Order No.
Size 4	for wall mounting	snap on	GHG 610 1953 R0126
Size 4	for trellis mounting	snap on	GHG 610 1953 R0126
Size 4	for pipe clamp	snap on	GHG 610 1953 R0130

Plug cap for plugs 16 A

Type	Order No.
Plug 16 A 3-pole	GHG 510 1901 R0001
Plug 16 A 4-pole	GHG 510 1901 R0002
Plug 16 A 5-pole	GHG 510 1901 R0003

Accessories for mounting plates

Type	OU	Order No.
Mounting set for pipes 1" (Ø 27 - 30 mm) for mounting plates with pipe fixing	10	GHG 610 1953 R0020

Please pay attention that only order units (OU) according to the ordering details can be delivered.

Protective canopy for mounting plate

Type	Application	Order No.
Size 4	for mounting plate size 4, snap on	GHG 610 1955 R0107

Dimension drawing

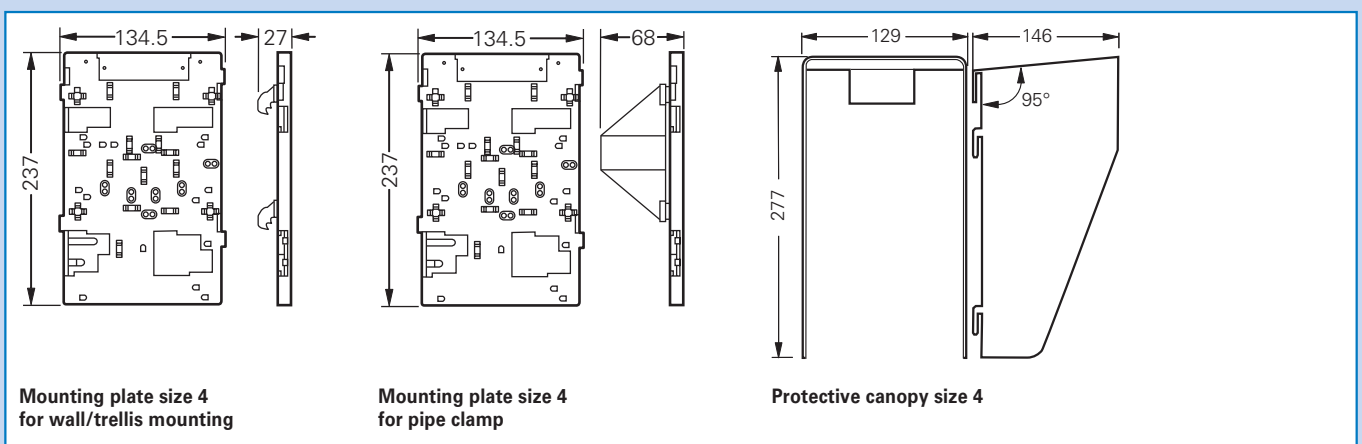

Mounting plate size 4 for wall/trellis mounting

Mounting plate size 4 for pipe clamp

Protective canopy size 4