



## Technical data

### Ex-plugs and receptacles acc. to IEC 60309-1/2 16A

Marking accd. to 94/9/EC	Ⓔ II 3 G Ex nC IIC T5/T6
EC-Type Examination Certificate	PTB 99 ATEX 1115
Permissible ambient temperature	-20°C up to +40°C <sup>1)</sup>
Rated voltage	up to 400 V (3-pole) / 750 V (4-pole) / 500 V (5-pole) AC
Rated current	up to 16 A
Frequency	up to 400 Hz
Rated making / Rated breaking capacity AC-3 accd. EN 60947-3	400 V / 16 A
External back-up fuse, max.	without therm. protection: 16 A with therm. protection: 35 A gL (rated current 16 A set to)
Protection class	I
Degree of protection accd. to EN 60529	IP66

#### Wall socket

Cable entry	1 x M25 Ø 8 - 17 mm, 1 x M25 plastic Ex-screw plug or 2 x metal thread M20 with plastic Ex-screw plug
Connecting terminals	2 x 1.5 - 4 mm <sup>2</sup>
Enclosure material	glass-fibre reinforced polyester

#### Plug

Cable entry	Ø 8 - 19 mm (3-pole) / Ø 8 - 21 mm (4-pole) / 12 - 21 mm (5-pole)
Connecting terminals	1 x 1.0 - 2.5 mm <sup>2</sup>
Enclosure material	Polyamide

#### Coupler

Cable entry	Ø 8 - 19 mm (3-pole) / Ø 8 - 21 mm (4-pole) / 12 - 21 mm (5-pole)
Connecting terminals	2 x 1.5 - 4 mm <sup>2</sup>
Enclosure material	Polyamide

#### Flange socket

Connecting terminals	2 x 1 - 4 mm <sup>2</sup>
Enclosure material	Polyamide

<sup>1)</sup> extended temperature range on request

**| Zone 2: 16A 3-pole, 4-pole and 5-pole up to 690 V |**



**Ordering details**

Voltage	h	Type	Cable entry	Weight approx.	Order No.
<b>Type 16 A 3-pole</b>					
110-130 V		Wall socket	KU	1.2 kg	<b>GHG 516 4304 R0001</b>
		Wall socket	ME	1.3 kg	<b>GHG 516 4304 R3001</b>
		Flange socket		0.4 kg	<b>GHG 516 8304 R0001</b>
		Coupler		0.7 kg	<b>GHG 516 3304 R0001</b>
		Plug		0.35 kg	<b>GHG 516 7304 R0001</b>
200-250 V		Wall socket	KU	1.2 kg	<b>GHG 516 4306 R0001</b>
		Wall socket	ME	1.3 kg	<b>GHG 516 4306 R3001</b>
		Flange socket		0.4 kg	<b>GHG 516 8306 R0001</b>
		Coupler		0.7 kg	<b>GHG 516 3306 R0001</b>
		Plug		0.35 kg	<b>GHG 516 7306 R0001</b>
<b>Type 16 A 4-pole</b>					
200-250 V		Wall socket	KU	1.8 kg	<b>GHG 516 4409 R0001</b>
		Wall socket	ME	1.9 kg	<b>GHG 516 4409 R3001</b>
		Flange socket		1.0 kg	<b>GHG 516 8409 R0001</b>
		Coupler		1.7 kg	<b>GHG 516 3409 R0001</b>
		Plug		0.7 kg	<b>GHG 516 7409 R0001</b>
380-415 V		Wall socket	KU	1.8 kg	<b>GHG 516 4406 R0001</b>
		Wall socket	ME	1.9 kg	<b>GHG 516 4406 R3001</b>
		Flange socket		1.0 kg	<b>GHG 516 8406 R0001</b>
		Coupler		1.7 kg	<b>GHG 516 3406 R0001</b>
		Plug		0.7 kg	<b>GHG 516 7406 R0001</b>
480-500 V		Wall socket	KU	1.8 kg	<b>GHG 516 4407 R0001</b>
		Wall socket	ME	1.9 kg	<b>GHG 516 4407 R3001</b>
		Flange socket		1.0 kg	<b>GHG 516 8407 R0001</b>
		Coupler		1.7 kg	<b>GHG 516 3407 R0001</b>
		Plug		0.7 kg	<b>GHG 516 7407 R0001</b>
600-690 V		Wall socket	KU	1.8 kg	<b>GHG 516 4405 R0001</b>
		Wall socket	ME	1.9 kg	<b>GHG 516 4405 R3001</b>
		Flange socket		1.0 kg	<b>GHG 516 8405 R0001</b>
		Coupler		1.7 kg	<b>GHG 516 3405 R0001</b>
		Plug		0.7 kg	<b>GHG 516 7405 R0001</b>
<b>Type 16 A 5-pole</b>					
200-250 V		Wall socket	KU	1.8 kg	<b>GHG 516 4506 R0001</b>
380-415 V		Wall socket	ME	1.9 kg	<b>GHG 516 4506 R3001</b>
		Flange socket		1.0 kg	<b>GHG 516 8506 R0001</b>
		Coupler		1.7 kg	<b>GHG 516 3506 R0001</b>
		Plug		0.7 kg	<b>GHG 516 7506 R0001</b>

other voltage ranges and versions, e.g. with aux. contact, on request  
 KU = 1 x plastic cable glands M25 Ø 8-17 mm, 1 x M25 plastic Ex-screw plug  
 ME = 2 x metal thread M20 with plastic Ex-screw plug



Dimension drawing | Wiring diagram

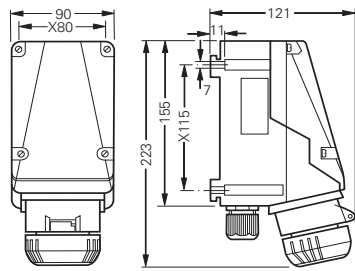

Wall socket 3-pole

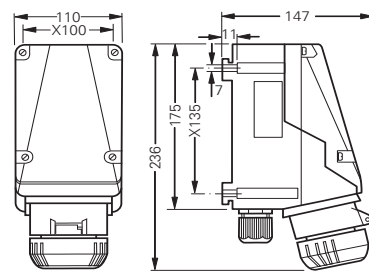

Wall socket 4/5-pole

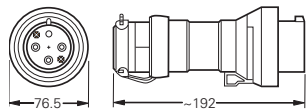

Plug 3-pole

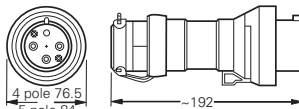

Plug 4/5-pole

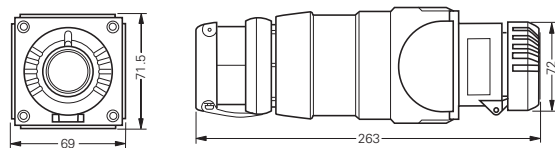

Coupler 3-pole

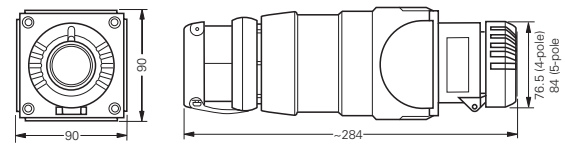

Coupler 4/5-pole

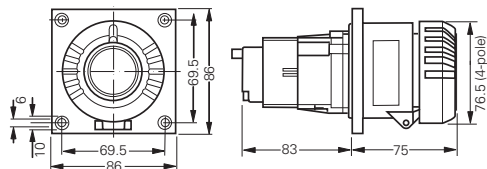

Flange socket 3-pole

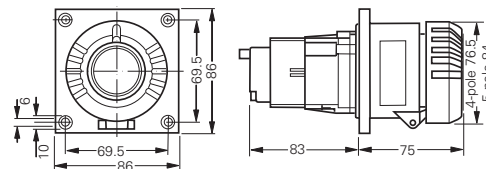

Flange socket 4/5-pole

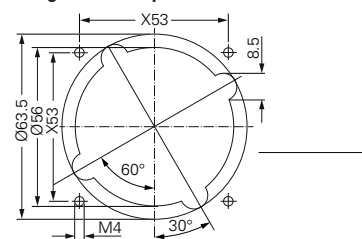

Assembly dimensions flange socket

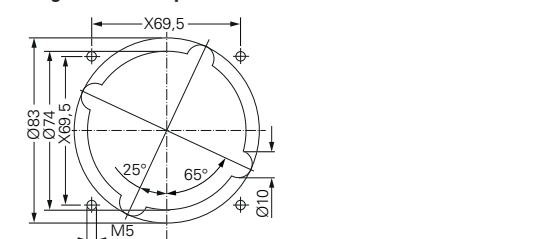

Assembly dimensions flange socket X = fixing dimensions

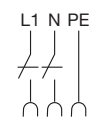

1P + N + PE

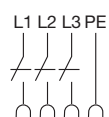

3P + PE

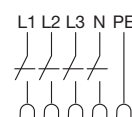

3P + N + PE

**| Zone 2: 16A 3-pole, 4-pole and 5-pole up to 690 V |**



Mounting plate



Plug cap



Protective canopy

1

**Accessories**

**Mounting plates for wall sockets 16 A**

Type	Application	Fixing method	Order No.
Size 4	for wall mounting	snap on	<b>GHG 610 1953 R0126</b>
Size 4	for trellis mounting	snap on	<b>GHG 610 1953 R0126</b>
Size 4	for pipe clamp	snap on	<b>GHG 610 1953 R0130</b>

**Plug cap for plugs 16 A**

Type	Order No.
Plug 16 A 3-pole	<b>GHG 510 1901 R0001</b>
Plug 16 A 4-pole	<b>GHG 510 1901 R0002</b>
Plug 16 A 5-pole	<b>GHG 510 1901 R0003</b>

**Accessories for mounting plates**

Type	OU	Order No.
Mounting set for pipes 1" (Ø 27 - 30 mm) for mounting plates with pipe fixing	10	<b>GHG 610 1953 R0020</b>

Please pay attention that only order units (OU) according to the ordering details can be delivered.

**Protective canopy for mounting plate**

Type	Application	Order No.
Size 4	for mounting plate size 4, snap on	<b>GHG 610 1955 R0107</b>

**Dimension drawing**

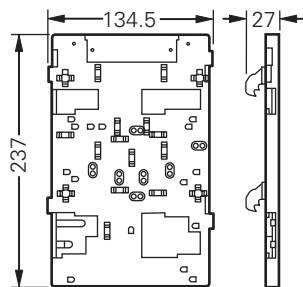

Mounting plate size 4  
for wall/trellis mounting

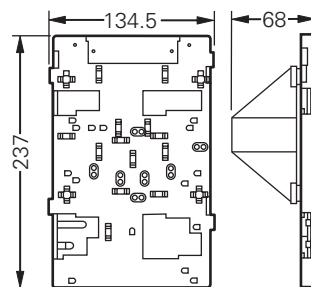

Mounting plate size 4  
for pipe mounting

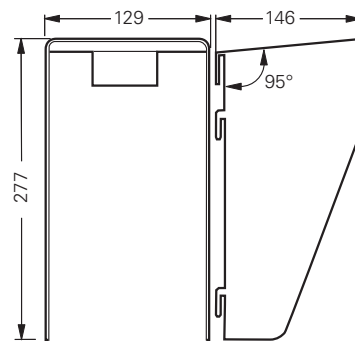

Protective canopy size 4

Dimensions in mm