



Technical data

Ex-wall socket 16 A- 125 A acc. to IEC 60309-1/2 up to 690 V

| | |
|--|---|
| Marking accd. to 94/9/EC | ⊕ D II 2 G Ex ed IIC T6 / ⊕ D II 2 D Ex tD A21 IP66 T80°C |
| Permissible ambient temperature | -20 °C to +40 °C ¹⁾ |
| Rated voltage | 230/400 V AC |
| Frequency | 50/60 Hz |
| Protection class | I |
| Degree of protection accd. to EN 60529 | IP66 |
| Enclosure material | glass-fibre reinforced polyester |

Wall socket 16 A

| | |
|--|--|
| EC-Type Examination Certificate | PTB 99 ATEX 1039 |
| Rated making / Rated breaking capacity | AC-3 accd. EN 60947-3: U _g 690 V / I _g 16 A |
| Cable entry | 1 x M25 Ø 8 - 17 mm, 1 x M25 thread plug plastic |
| Rated current | 16 A |
| External back-up fuse, max. | without therm. protection: 16 A/ with therm. protection 35 A gL (rated current 16 A set to) |
| Connecting terminals | 2 x 1.5 - 4 mm ² |

Wall socket 32 A

| | |
|--|--|
| EC-Type Examination Certificate | PTB 99 ATEX 1044 |
| IECEX Certificate of conformity | IECEX BK1 06.0007 |
| Marking accd. to IECEx | Ex de ia/ib m [ia/ib] IIC T4...T6 |
| Rated making / Rated breaking capacity | AC-3 accd. EN 60947-3: U _g 690 V / I _g 32 A |
| Cable entry | 1 x M40 Ø 17 - 28 mm, 1 x M40 thread plug plastic |
| Rated current | 32 A |
| External back-up fuse, max. | without therm. protection: 32 A/ with therm. protection 50 A gL (rated current 32 A set to) |
| Connecting terminals | 2 x 4 - 10 mm ² |

Wall socket 63 A

| | |
|--|--|
| EC-Type Examination Certificate | PTB 00 ATEX 1070 |
| Rated making / Rated breaking capacity | AC-3 accd. EN 60947-3: U _g 690 V / I _g 63 A |
| Cable entry | 1 x M50 Ø 22 - 35 mm, 1 x M50 thread plug plastic |
| Rated current | 63 A |
| External back-up fuse, max. | without therm. protection: 63 A/ with therm. protection 80 A gL (rated current 63 A set to) |
| Connecting terminals | 2 x 4 - 25 mm ² |

Wall socket 125 A

| | |
|--|---|
| EC-Type Examination Certificate | PTB 01 ATEX 1069 |
| Rated making / Rated breaking capacity | AC-3 accd. EN 60947-3: U _g 690 V / I _g 125 A |
| Cable entry | 1 x M63 Ø 27 - 48 mm, 1 x M63 thread plug plastic |
| Rated current | 125 A |
| External back-up fuse, max. | without therm. protection: 125 A/ with therm. protection 125 A gL (rated current 125 A set to) |
| Connecting terminals | 2 x 4 - 70 mm ² |

¹⁾ extended temperature range on request

Ex-Wall sockets 16 A- 125 A with status LED



Wall socket 16 A



Wall socket 32 A



Wall socket 63 A



Wall socket 125 A

Ordering details 16/32/63/125 A 3-pole, 4-pole and 5-pole up to 415V

| Voltage | h | Type | Weight approx. | Order No. |
|------------------------|-----|----------------------|----------------|---------------------------|
| Type 16 A line | | | | |
| 110 V - 130 V | 4 h | Wall socket - 3 pole | 1.3 kg | GHG 511 4304 R0301 |
| 200 V - 250 V | 6 h | Wall socket - 3 pole | 1.3 kg | GHG 511 4306 R0301 |
| 110 V - 130 V | 4 h | Wall socket - 5 pole | 1.9 kg | GHG 511 4504 R0301 |
| 380 V - 415 V | 6 h | Wall socket - 5 pole | 1.9 kg | GHG 511 4506 R0301 |
| 240 V - 415 V | 8 h | Wall socket - 5 pole | 1.9 kg | GHG 511 4508 R0301 |
| Type 16 A load | | | | |
| 110 V - 130 V | 4 h | Wall socket - 3 pole | 1.3 kg | GHG 511 4304 R0351 |
| 200 V - 250 V | 6 h | Wall socket - 3 pole | 1.3 kg | GHG 511 4306 R0351 |
| 110 V - 130 V | 4 h | Wall socket - 5 pole | 1.9 kg | GHG 511 4504 R0351 |
| 380 V - 415 V | 6 h | Wall socket - 5 pole | 1.9 kg | GHG 511 4506 R0351 |
| 240 V - 415 V | 8 h | Wall socket - 5 pole | 1.9 kg | GHG 511 4508 R0351 |
| Type 32 A line | | | | |
| 110 V - 130 V | 4 h | Wall socket - 5 pole | 2.8 kg | GHG 619 0001 R0001 |
| 380 V - 415 V | 6 h | Wall socket - 5 pole | 2.8 kg | GHG 619 0001 R0002 |
| 380 V - 415 V | 8 h | Wall socket - 5 pole | 2.8 kg | GHG 619 0001 R0003 |
| Type 32 A load | | | | |
| 110 V - 130 V | 4 h | Wall socket - 5 pole | 2.8 kg | GHG 619 0001 R0004 |
| 380 V - 415 V | 6 h | Wall socket - 5 pole | 2.8 kg | GHG 619 0001 R0005 |
| 380 V - 415 V | 8 h | Wall socket - 5 pole | 2.8 kg | GHG 619 0001 R0006 |
| Type 63 A line | | | | |
| 110 V - 130 V | 4 h | Wall socket - 5 pole | 8.2 kg | GHG 514 4504 R0301 |
| 380 V - 415 V | 6 h | Wall socket - 5 pole | 8.2 kg | GHG 514 4506 R0301 |
| 380 V - 415 V | 8 h | Wall socket - 5 pole | 8.2 kg | GHG 514 4508 R0301 |
| Type 63 A load | | | | |
| 110 V - 130 V | 4 h | Wall socket - 5 pole | 8.2 kg | GHG 514 4504 R0351 |
| 380 V - 415 V | 6 h | Wall socket - 5 pole | 8.2 kg | GHG 514 4506 R0351 |
| 380 V - 415 V | 8 h | Wall socket - 5 pole | 8.2 kg | GHG 514 4508 R0351 |
| Type 125 A line | | | | |
| 110 V - 130 V | 4 h | Wall socket - 5 pole | 12.6 kg | GHG 515 4504 R0301 |
| 380 V - 415 V | 6 h | Wall socket - 5 pole | 12.6 kg | GHG 515 4506 R0301 |
| 380 V - 415 V | 8 h | Wall socket - 5 pole | 12.6kg | GHG 515 4508 R0301 |
| Type 125 A load | | | | |
| 110 V - 130 V | 4 h | Wall socket - 5 pole | 12.6 kg | GHG 515 4504 R0351 |
| 380 V - 415 V | 6 h | Wall socket - 5 pole | 12.6 kg | GHG 515 4506 R0351 |
| 380 V - 415 V | 8 h | Wall socket - 5 pole | 12.6 kg | GHG 515 4508 R0351 |

Other voltage ranges and h-codes on request.



Wall socket 16 A

Wall socket 32 A

Wall socket 63 A

Wall socket 125 A

Dimension drawing | Wiring diagram

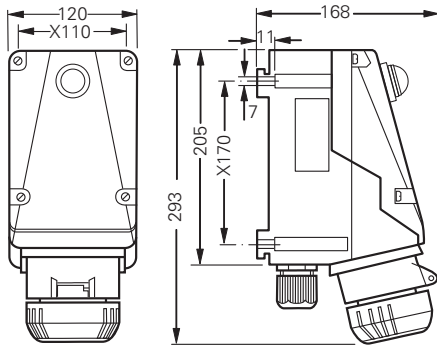

Wall socket 16 A 3-pole

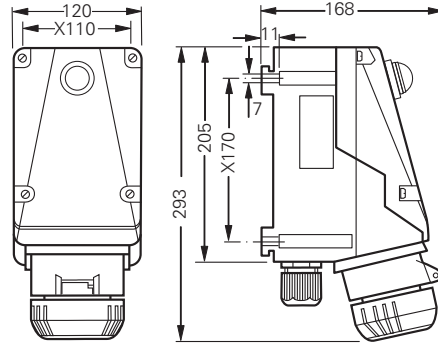

Wall socket 16 A 5-pole

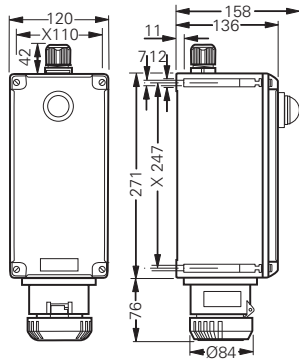

Wall socket 32 A 5-pole

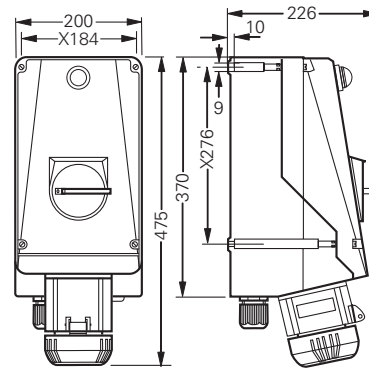

Wall socket 63 A 5-pole

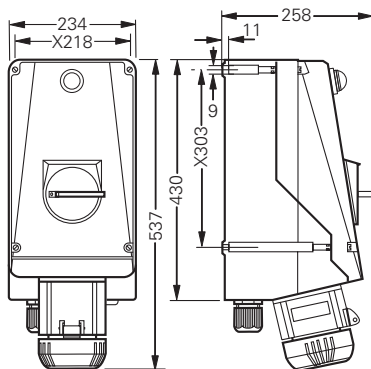

Wall socket 125 A 5-pole

X = fixing dimensions

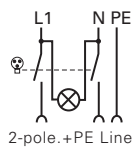

2-pole.+PE Line

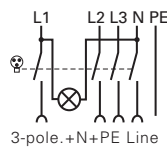

3-pole.+N+PE Line

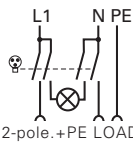

2-pole.+PE LOAD

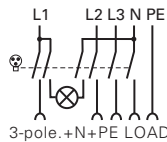

3-pole.+N+PE LOAD